

正样
2023.01.16
B01

外部公开

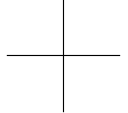
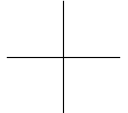

INOVANCE

Amendment	Description

Unit: Millimeter (mm)

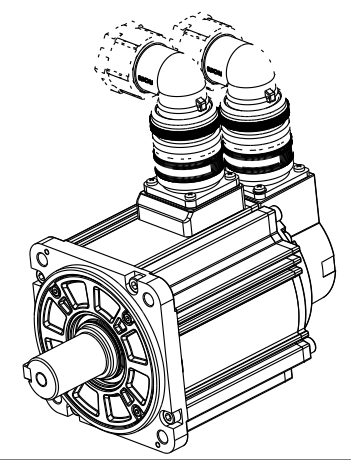
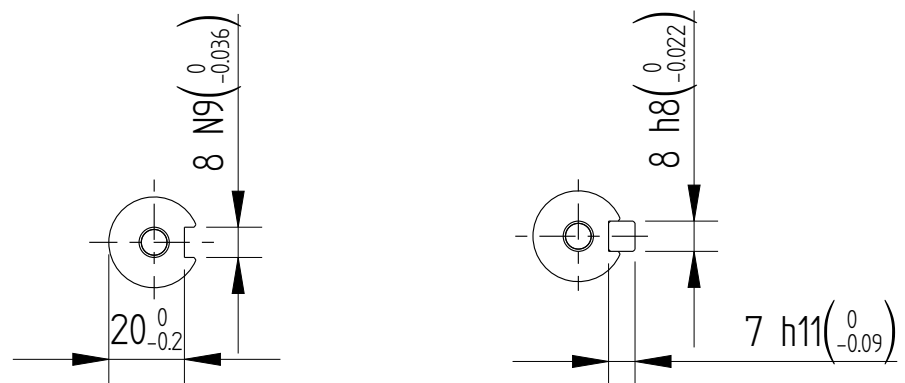
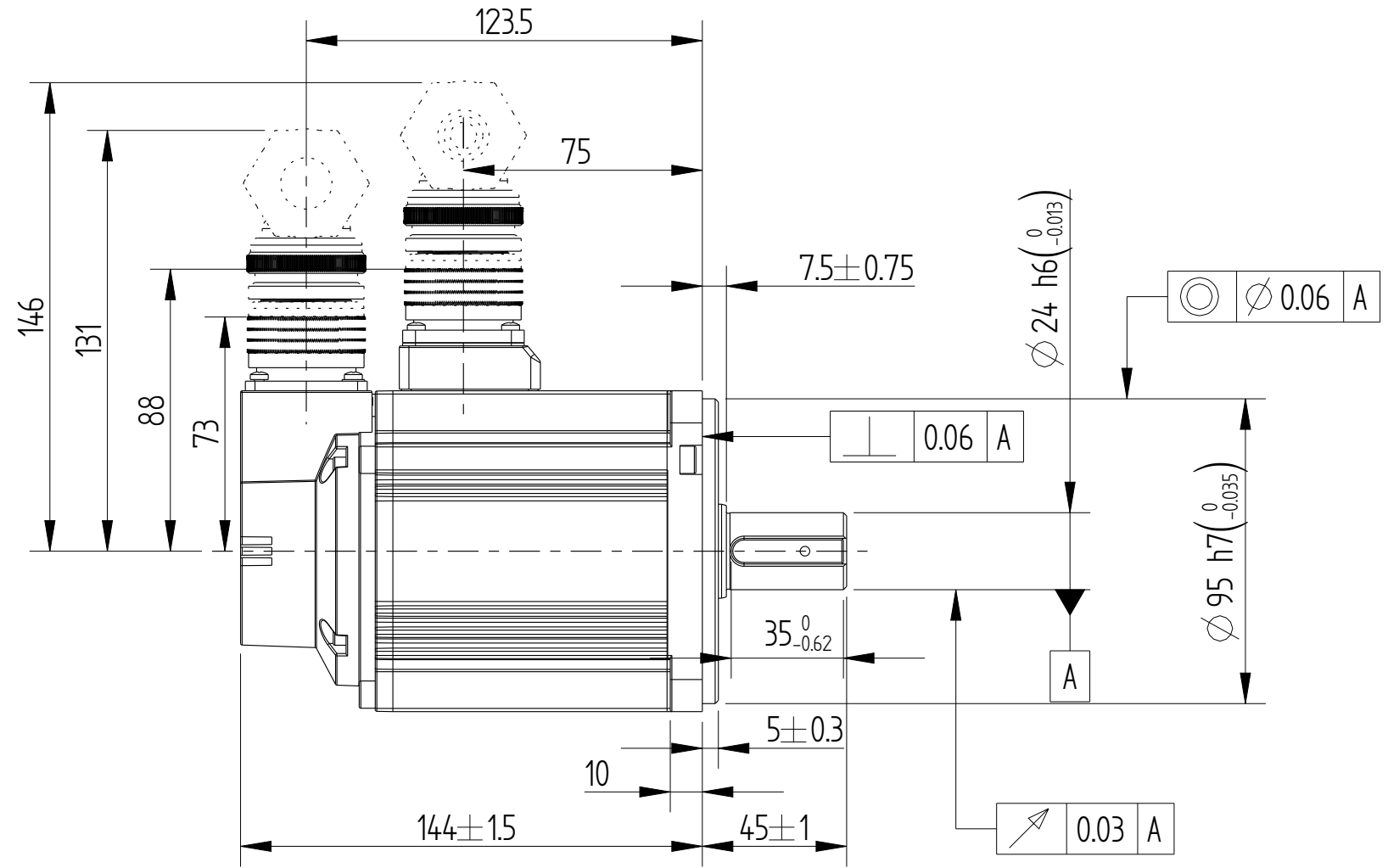
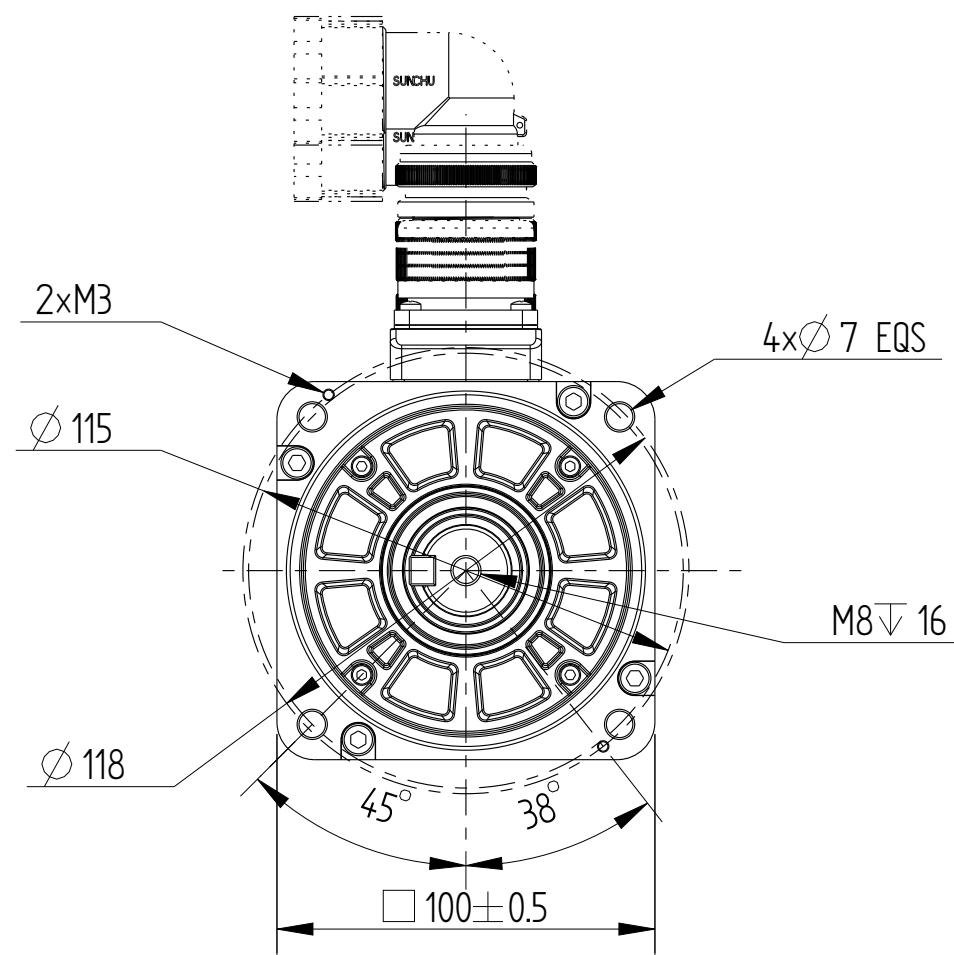

Dimension of shaft end Dimension of shaft end with key

Basic function parameters	
Rated power KW	1
Rated voltage V	380
Rated current A	3.3
Peak current at rated speed A	11
Rated torque Nm	3.18
Peak torque at rated speed Nm	9.54
Rated speed rpm	3000
Max speed rpm	6000
Rotor inertia kg·cm ²	1.78±10%
Encoder resolution	26bit
Insulation class	F(155° C)
Protection level	IP67
Static torque of brake Nm	/
Brake power supply	/
Duty cycle	S1
Radial line load N	≤686
Axial load N	≤196

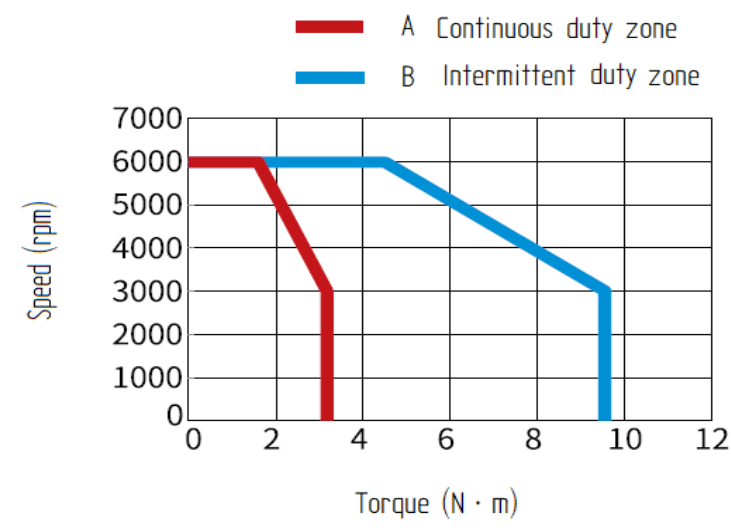

Motor Outline Drawing				01117884-WX	
B01	New Archive	/	20230912	Mark 	INOVANCE
Version	Change method	Changed by	Date		
Design	/	/	/		
Check	/	/	/		
Craft	/	/	/	Page 1 of 1	MS1H2-10C30-A631R-INT
Verify	/	/	/		
Standardization	/	/	/		
Approve	/	/	/	Weight	3.85kg
				Scale	12
				Version	B01
				Model	MS1H2-10C30-A631R-INT